

## TOP VIEW

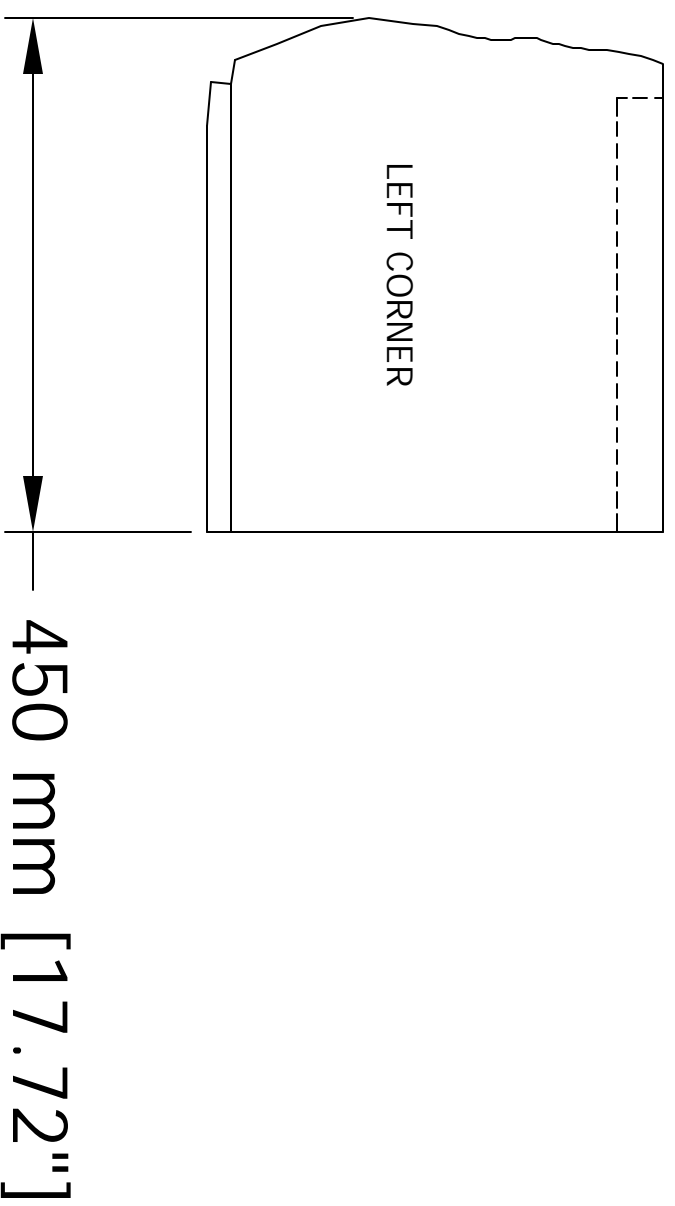
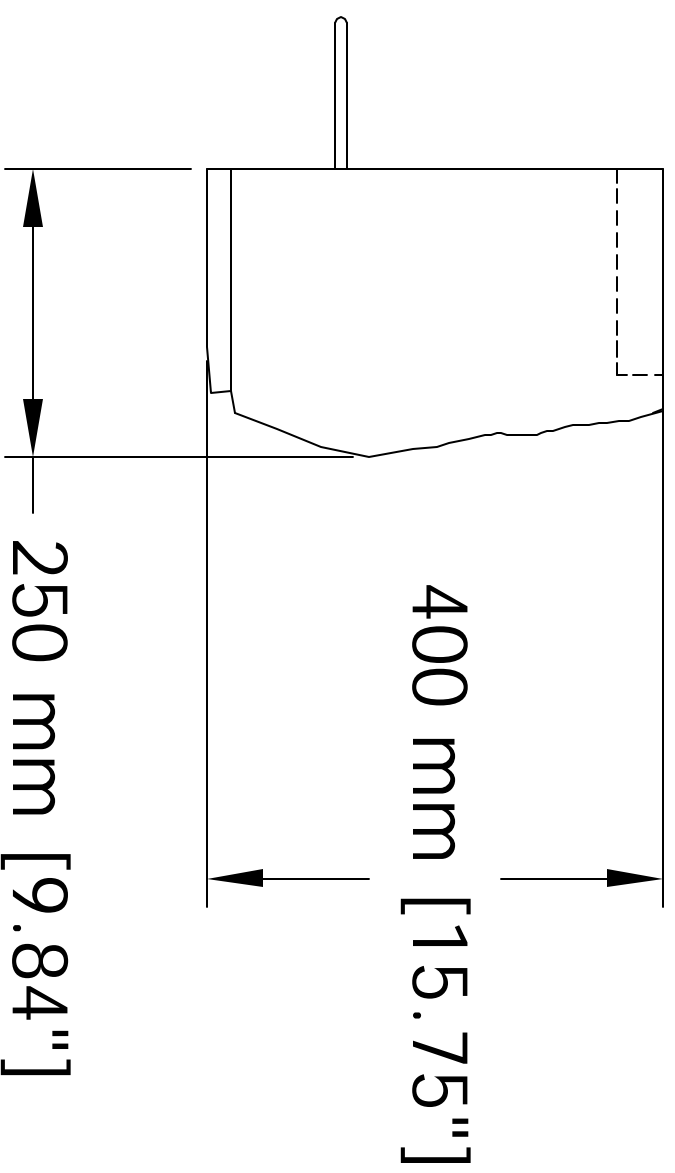

### COLOUR

LIMESTONE GREY

### REINFORCEMENT

1/4" OR 5/16" STAINLESS STEEL  
or

3/8" HOT DIPPED GALVANIZED  
STEEL

POLY OLAFIN FIBRE  
REINFORCEMENT

### STRENGTH

40 MPa (5500 p.s.i.) MIN

### PANEL WEIGHT

43 kg 93 lbs)

### NOTE:-

This drawing is a representation of a typical L+L component and delivered components may vary slightly due to the specific casting equipment used in their manufacture contact each manufacturer plant for specific shop drawings when required.

REV #	DESCRIPTION	DATE

**LOCK+LOAD**™

RETAINING WALL SYSTEMS  
181 CHESTNUT STREET SUITE 400 VANCOUVER, B.C. V6J 4A6  
Tel:(604) 732-9990 Toll Free: 1-877-901-9998 Fax: (604) 737-1140  
Web site: www.lock-load.com

LEFT HAND OUTSIDE CORNER LC-40

TYPICAL DRAWINGS

**BRAN E. KOTARBA** 2007.01.21  
PREPARED FOR

N.T.S. OUR PROJECT NUMBER OUR DRAWING NUMBER

CUSTOMER DRAWING CD-LC-40-001

## SIDE VIEWS